

INSTALLATION INSTRUCTIONS

DESCRIPTION: Winch Wiring Kit (Axon)

PART NUMBER: B4J-F28N0-S0

MODEL: 2021+ Wolverine RMax2 and RMax4



⚠ WARNING

Please read and understand these instructions completely before installation to avoid possible injury, or damage to the accessory or vehicle.

WARRANTY INFORMATION:

In the United States, see your Yamaha dealer for a copy of the Yamaha Genuine Parts and Accessories Limited Warranty.

NOTICE:

Installation of this kit requires a torque wrench and should be performed by an authorized Yamaha dealer or a qualified mechanic.

DEALER OR INSTALLER:

These instructions contain important information for future reference and *must* be given to the customer.

Note: This winch wiring kit is designed for the Warn Axon line of winches.

Do not use with the Warn VRX 4500 line of winches because it will void the warranty.

- Parts ⑪ and ⑫ are used to attach the winch to the stock front brush guard. Torque to 16Nm (1.6 m·kg or 11.8 lb·ft)

PARTS LIST:

No.	Part Number	Description	Qty
--	B4J-F28N0-S0	Winch Wiring Kit (Axon)	--
①	B4J-F637E-S0	Wire 1, Red	1
②	B4J-F637F-S0	Wire 2, Black	1
③	B4J-H7292-V0	Remote Wire Harness	1
④	B4J-H259E-V0	Switch	1
⑤	90464-80001	Cable Tie	12
⑥	90110-10092	M10x20 Socket Head Bolt	2
⑦	B4J-F4473-V0	#2 Phillips Screws	2
⑧	B4J-E4357-V0	Flat Washer	2
⑨	B4J-H259F-V0	Switch, Hand Held	1
⑩	B4J-H2371-V0	Remote Plug Cap	1
⑪	BAR-E1026-V0	M8x20 Hex Head Cap Screw	4
⑫	92902-08100	M8 Lock Washers	4

* Part supplied with kit only and not available separately.

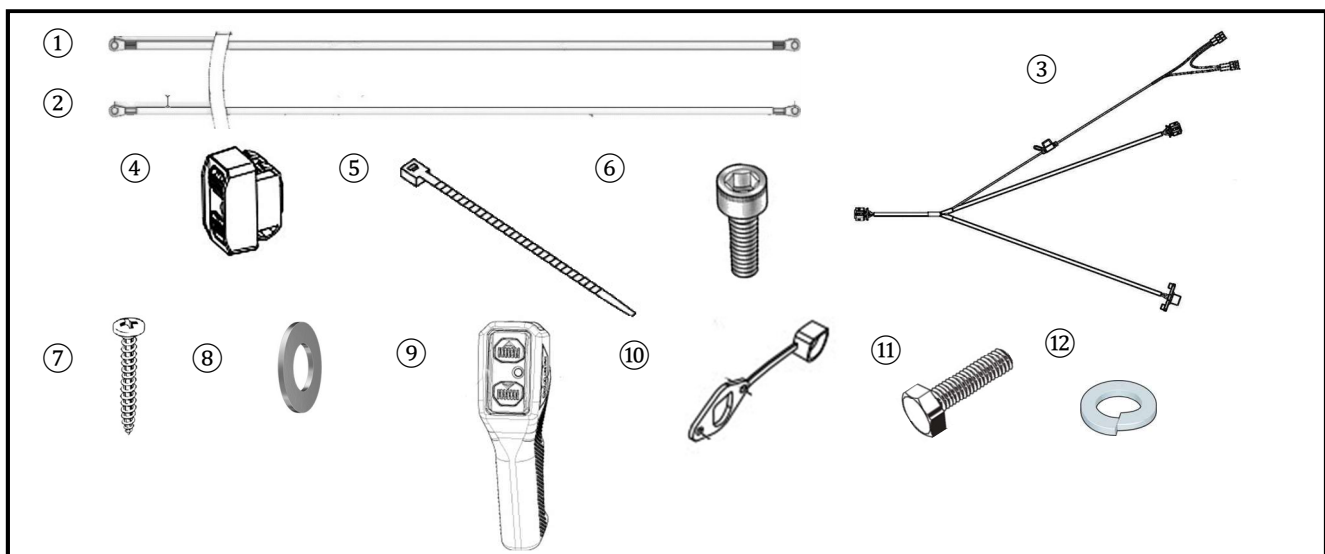

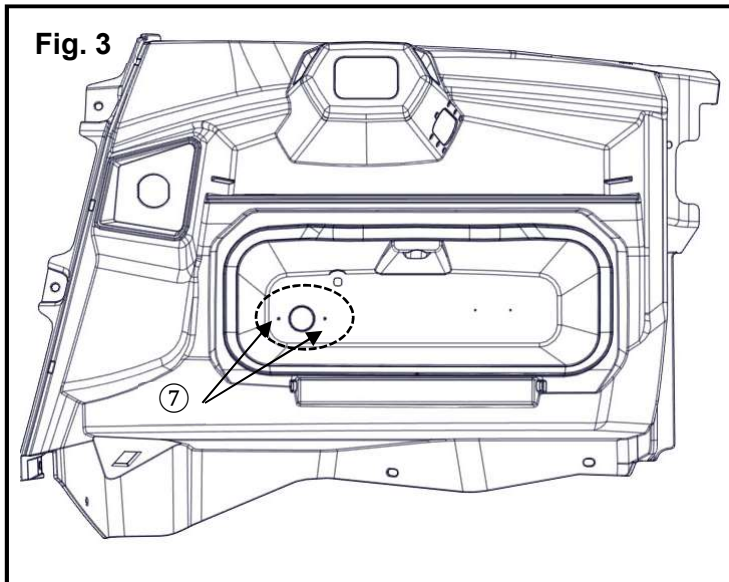
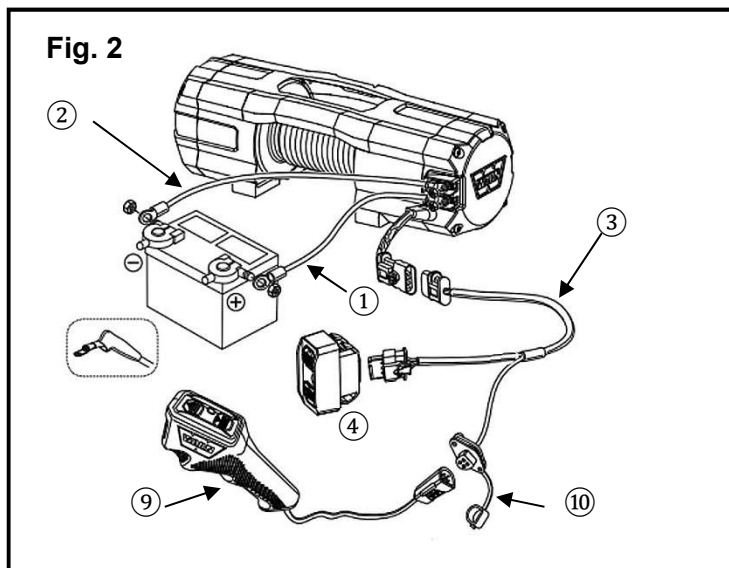
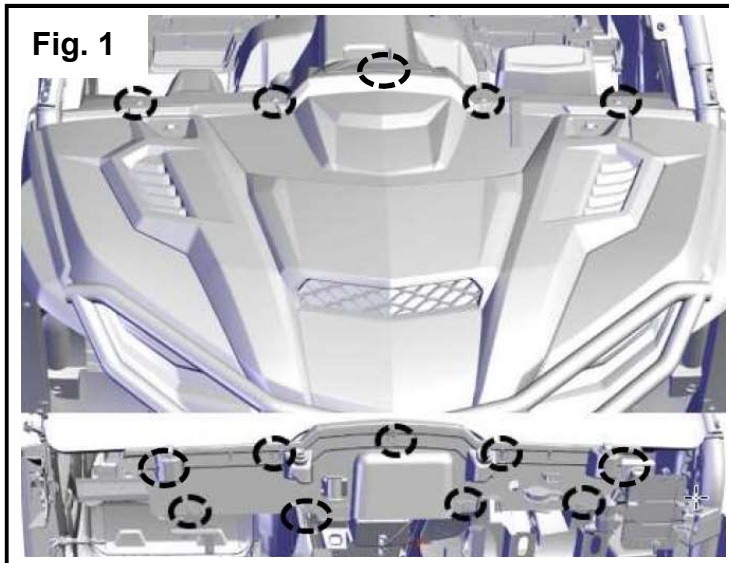

PREPARATION:

- Place the vehicle on a secure and level surface.
- Set the parking brake.
- Clean the mounting surfaces before beginning installation.
- Disconnect the battery cables from the battery.

PARTS REMOVAL:

1. Remove the hood and the inner firewall.
Retain the hardware for reinstallation. (Fig. 1)

INSTALLATION:

1. Install the winch in accordance to the instructions from the manufacture. Use the ⑪+⑫ hardware from this kit to attach it to the front brush guard.
2. Install boots supplied in the winch kit to all four ring terminal connectors in the kit. The winch is color coded for the terminal connections. (Fig. 2)
3. Install the ① WIRE 1, Red to the (+) terminal on the winch. (Fig. 2)
4. Install the ② WIRE 2, Black to the (-) terminal on the winch. (Fig. 2)
5. Connect the ③ Remote Wire Harness to the winch. Route it up and behind the grill. Use ⑤ Cable Ties to secure the two wires to the vehicle. (Fig. 6)
6. Route the ① WIRE 1, Red and ② WIRE 2, Black wires to the battery location. Leave the battery disconnected. Do not attach the wires to the battery until Step 14.

INSTALL THE REMOTE WIRE HARNESS

7. The ③ Remote Wire Harness in this Winch Wiring Kit includes the connector for the Winch's remote control and for the rocker switch. The mounting hardware is included in this kit. (Fig. 2)
8. Look for a 7/8" circle inside the glovebox. This is the mounting location for the remote switch in the bottom of the glovebox. Drill a pilot hole, and then use a hole saw to cut a 7/8" hole for the connector, feed the ③ Remote Wire Harness to the back of the hole. Route the other end of ③ Remote Wire Harness to the winch. Coil up excess wire and secure them with cable ties. (Fig. 3 and 4)
9. Remove both plastic bosses on the back side of the glove box and drill out pilot holes for the screw holes with a 3mm drill bit. (Fig. 5)
10. Place the ⑩ Remote Plug Cap over the plug.
11. Use two ⑦ #2 Phillips Head screws and two ⑧ Flat Washers to secure both the ③ Remote Wire harness and the ⑩ Remote Plug Cap to the glovebox. (Fig. 4)
12. Remove one of the center console hole covers to mount the ④ Switch.

Fig. 4

Back of the glove box.

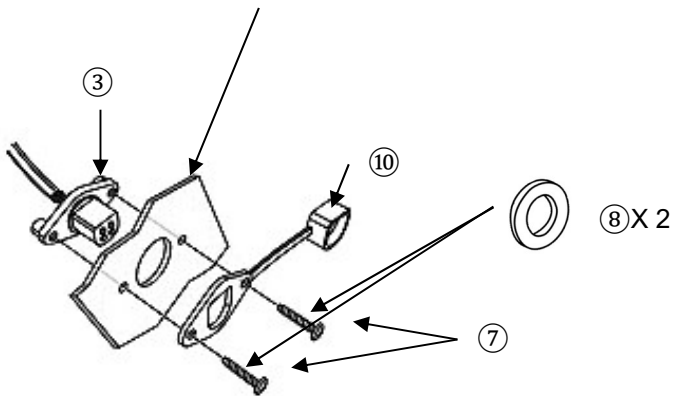

13. Place the (3) Remote Wire Harness on the (4) Switch and press it into the center console hole.
14. Reinstall the firewall with the stock hardware and torque to 8 Nm. (5.9 ft-lb and 0.8 m-kg)
15. Reconnect the battery terminals and winch wires from Step 5 to the battery. (Fig. 7)
16. Use two (6) M10x20 Socket Head Bolts to attach the fair lead. Torque to 16 Nm (12 Ft-Lb or 1.6 m-kg).

MAINTENANCE:

Periodically, check torque on all hardware. If loose hardware is found, re-torque to specification.

CARE AND CLEANING:

Clean painted metal parts with a clean soft cloth and mild soap and water solution. Rinse and dry.

CUSTOMER SERVICE:

For further information see your Yamaha dealer.

ESTIMATED TIME TO INSTALL: 1.0 HRS.

Fig. 5

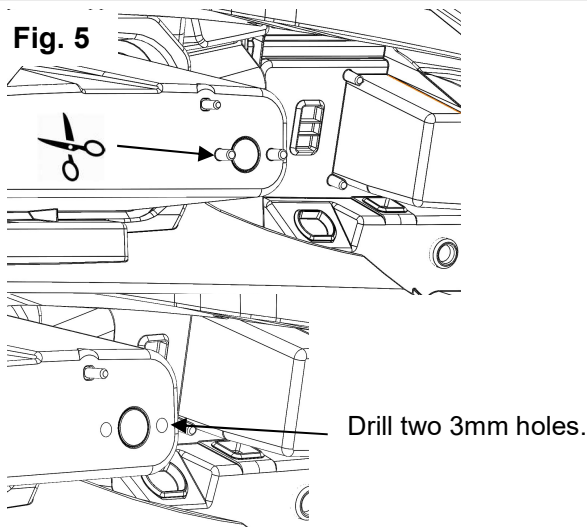

Fig. 6

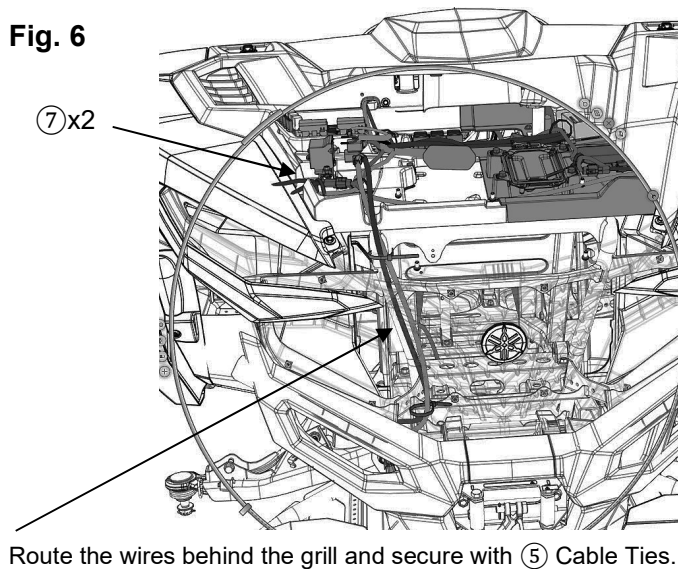

Fig. 7

